

# MLRK 1-VD22

## INSERT INSTRUCTIONS

The Command Access MLRK1 is a field-installable motorized latch-retraction kit for:

- MLRK1-VD22 - Von Duprin 22 series devices

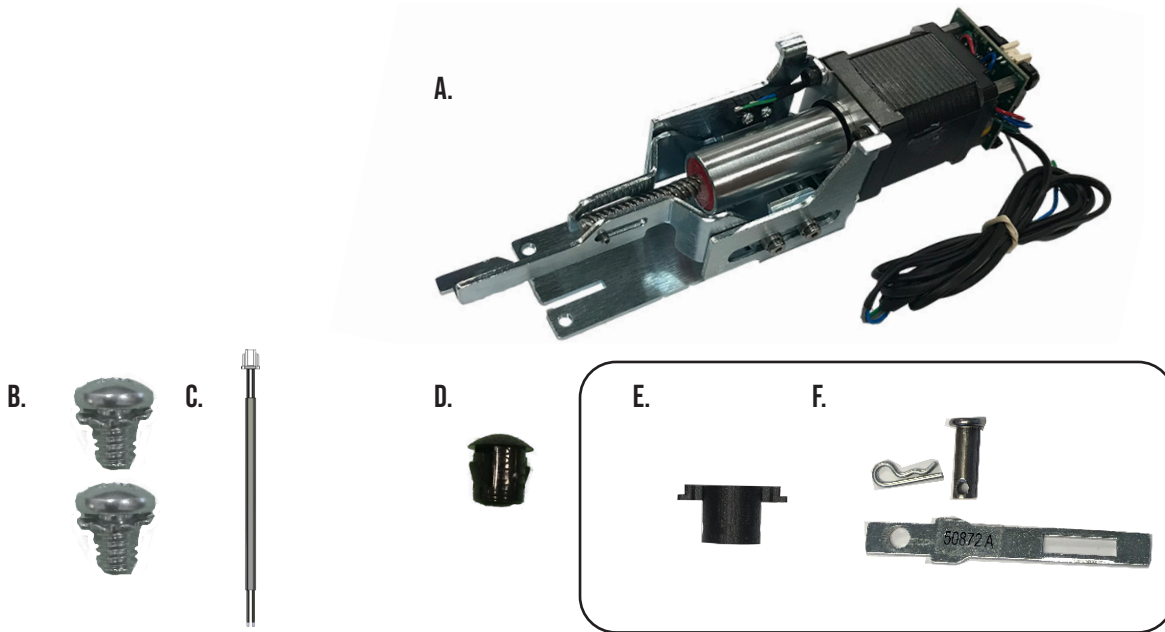

### KIT INCLUDES

- A. 1- 60343 Motor Mount w/ MM5 series module
- B. 2- 40002 8/32 X 1/4" Phillips head screws
- C. 1- 50944 Molex Pigtail
- D. 1- 40144 Dogging Hole Cap
- E. 1- 50872- Fire Rated Drilling Template (Old Devices)

### TOOLS REQUIRED

- Cordless Drill
- Hammer & Pin Punch(recommend)
- 3/16 & 3/32 drill bit
- 5/16 Nut driver (recommended)
- #2 Phillips head screwdriver

### FIRE RATED DOGGING KIT

- F. 1- Replacement Dogging Tail Piece (40006 + 40800 + 50872)

### SPECIFICATIONS:

- Input Voltage: 24VDC +/- 10%
- Average Latch Retraction Current: 900mA
- Average Holding Current: 200mA
- Wire Gauge: Minimum 18 gauge
- Direct wire run - no relays or access control units in-between power supply & module

### RECOMMENDED POWER SUPPLIES:

ALL COMMAND ACCESS EXIT DEVICES & FIELD INSTALLABLE KITS HAVE BEEN THOROUGHLY CYCLE TESTED WITH COMMAND ACCESS POWER SUPPLIES AT OUR FACTORY. IF YOU PLAN ON USING A NON-COMMAND POWER SUPPLY IT MUST BE A FILTERED & REGULATED LINEAR POWER SUPPLY.

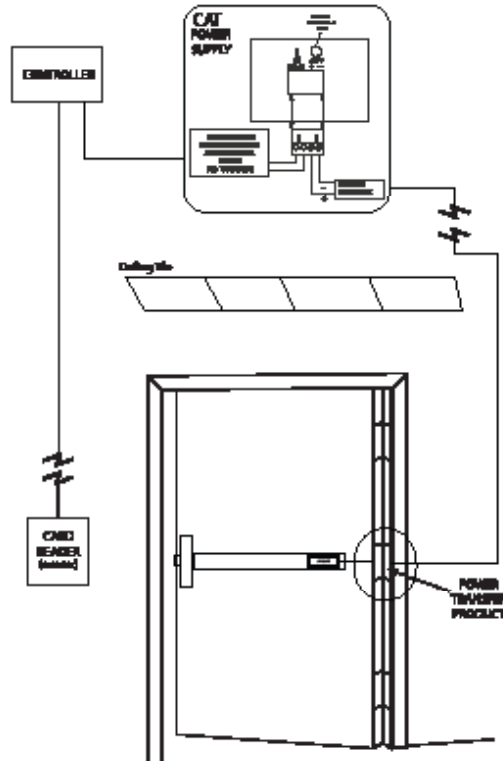

## SETTING PTS

**\*\*IMPORTANT INFO\*\***

**MAKE SURE TO SET PTS BEFORE FINISHING INSTALLATION**

- STEP 1 -** TO ENTER PTS MODE: DEPRESS MM5 BUTTON & APPLY POWER. THE DEVICE WILL EMIT 1 SHORT BEEP. THE DEVICE IS NOW IN PTS MODE.
- STEP 2 -** WHILE DEPRESSING THE PUSH PAD, APPLY POWER. (I.E. PRESENTING THE CREDENTIAL TO THE READER).
- STEP 3 -** CONTINUE TO KEEP PAD DEPRESSED, THE DEVICE WILL EMIT 1 LONG BEEP. AFTER THE BEEP HAS STOPPED, RELEASE THE PAD AND NOW THE ADJUSTMENT IS COMPLETE. TEST THE NEW LOCATION, IF NOT TO YOUR LIKING REPEAT THE 3 STEPS.

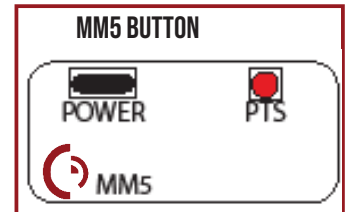

## TROUBLESHOOTING & DIAGNOSTICS

BEEPS	EXPLANATION	SOLUTION
1 SHORT BEEP	PUSH TO SET	DEVICE IS READY TO RECORD ITS NEW POSITION.
1 LONG BEEP	PUSH TO SET	DEVICE HAS RECORDED IT'S NEW POSITION.
2 BEEPS	OVER VOLTAGE	> 30V UNIT WILL SHUT DOWN. CHECK VOLTAGE & ADJUST TO 24 V.
3 BEEPS	UNDER VOLTAGE	< 20V UNIT WILL SHUT DOWN. CHECK VOLTAGE & ADJUST TO 24 V.
4 BEEPS	FAILED SENSOR	VERIFY ALL 3 SENSOR WIRES ARE INSTALLED CORRECTLY. REPLACE SENSOR IF PROBLEM PERSISTS BY CONTACTING OFFICE.
5 BEEPS	RETRACTION OR DOGGING FAILURE	AFTER 1ST FAIL: 5 BEEPS THEN IMMEDIATELY ATTEMPTS TO RETRACT AGAIN. AFTER 2ND FAIL: 5 BEEPS WITH PAUSE IN-BETWEEN FOR 30 SECONDS THEN DEVICE ATTEMPTS TO RETRACT AGAIN. AFTER 3RD FAIL: 5 BEEPS EVERY 7 MINUTES, DEVICE WILL NOT ATTEMPT TO RETRACT. TO RESET: DEPRESS BAR FOR 5 SECONDS AT ANY TIME.

# INSTALLATION INSTRUCTIONS

- 1.** REMOVE HEADCOVER & SLIDE OFF FILLER PLATE.

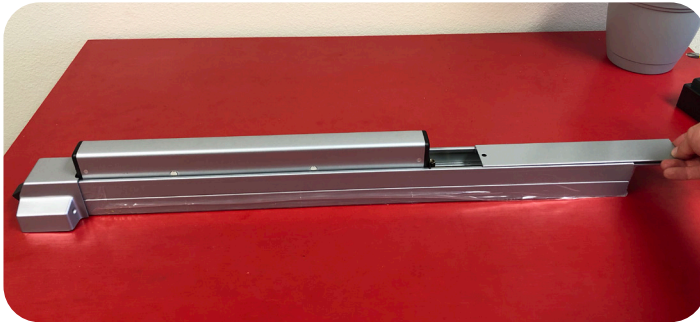

- 2.** FLIP DEVICE OVER & REMOVE (4) SCREWS.

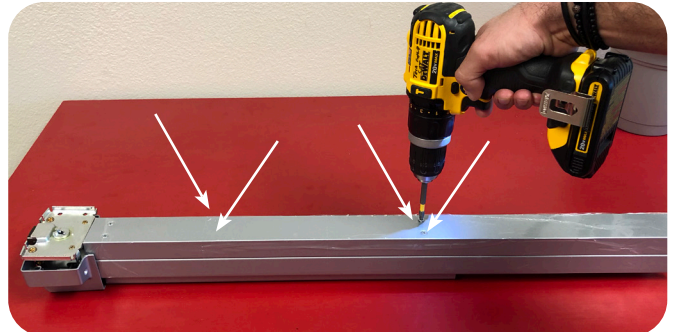

- 3.** FLIP OVER DEVICE BACK OVER & SLIDE OFF HOUSING.

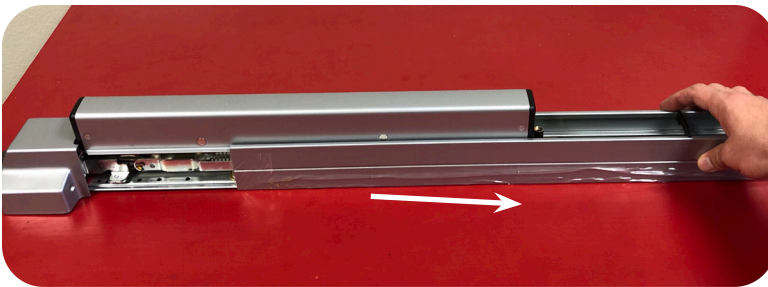

- 4.** REMOVE PUSH PAD FROM BASERAIL.

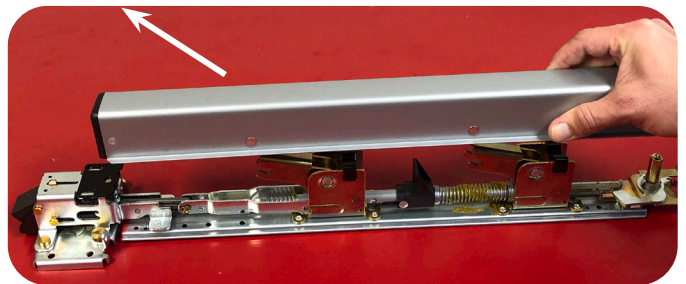

- 5.** IF YOUR DEVICE HAS DOGGING, FLIP BASERAIL OVER & REMOVE (2) SCREWS SECURING DOGGING ASSEMBLY TO RAIL. IF YOU HAVE AN OLDER DEVICE WITH RIVETS, YOU WILL NEED TO DRILL THEM OUT OR USE A PIN PUNCH TO KNOW THEM OUT.





# INSTALLATION INSTRUCTIONS

## FIRE RATED DEVICES ONLY - NON-RATED DEVICES SKIP TO STEP 8



6. USE REPLACEMENT DOGGING TAIL (50872) PROVIDED, & INSERT INTO CONNECTION ROD.

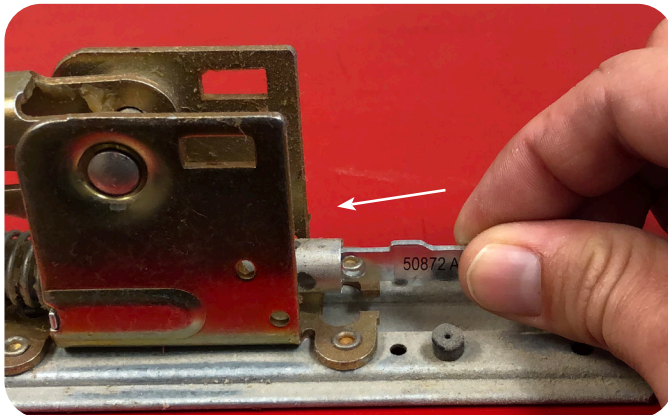

7. LINE HOLES UP & INSERT PIN TO ATTACH, SECURE WITH CLIP PROVIDED. IF YOUR DEVICE DOES NOT HAVE THE FACTORY HOLE, PLEASE SCAN THE QR CODE FOR FURTHER INSTRUCTIONS.

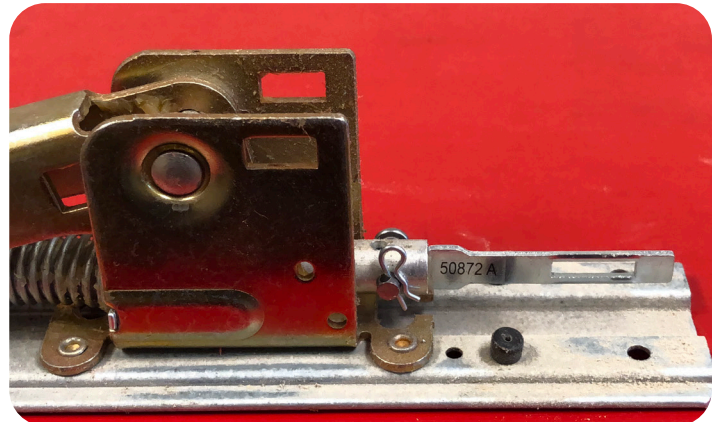

8. GRAB YOUR MOTOR AND INSERT ATTACHING BRACKET AT SLIGHT ANGLE THROUGH THE WINDOW ON THE DOGGING TAIL.

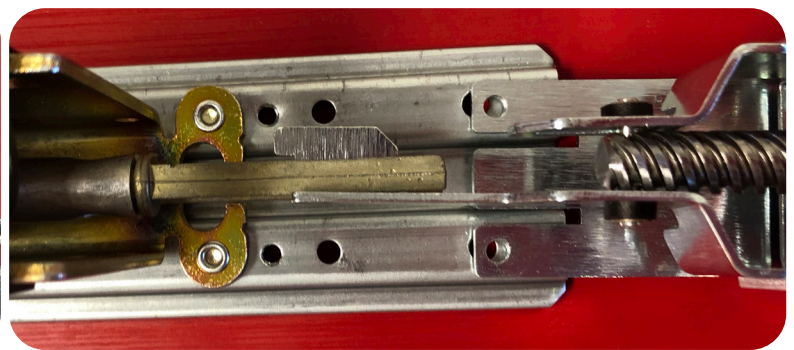
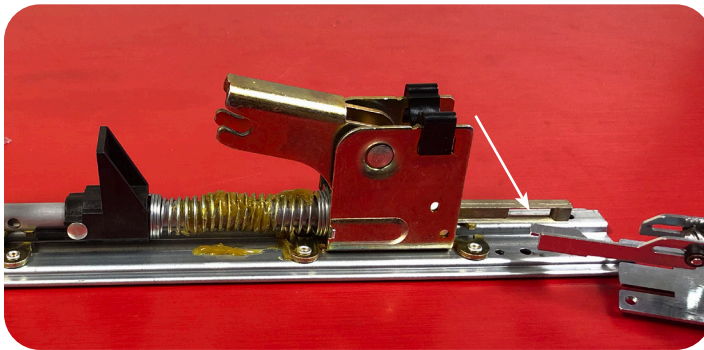

9. STRAIGHTEN KIT & PULL BACK TO SLIDE MOUNTING BRACKET UNDERNEATH BASERAIL.

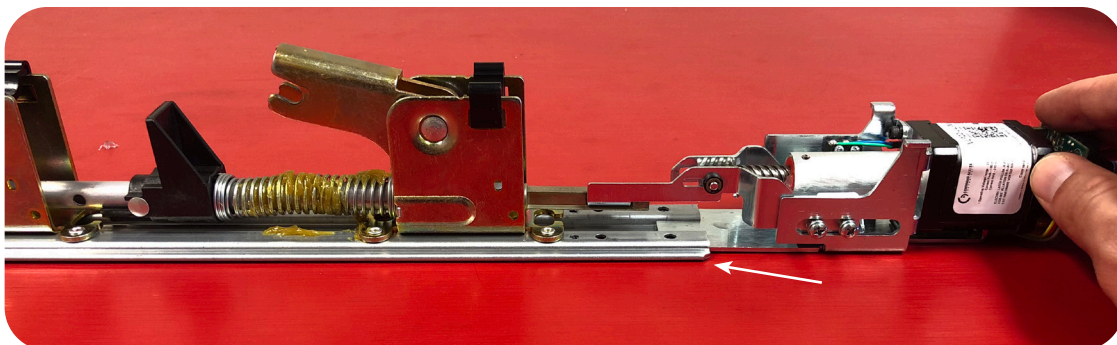

# INSTALLATION INSTRUCTIONS

**10. SECURE MOTOR KIT TO BASERAIL BY INSTALLING (2) SCREWS PROVIDED.**

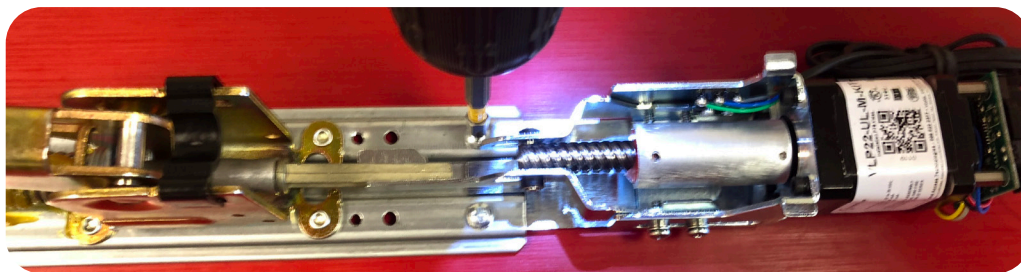

**11. RE-ASSEMBLE DEVICE BY PUTTING PUSH PAD ON & SLIDING HOUSING BACK ON. YOU MIGHT HAVE TO OPEN HOUSING UP A LITTLE BIT BY HAND IF IT'S A TIGHT SQUEEZE.**



**12. FLIP OVER RE-INSTALL (4) SCREWS TO SECURE BASERAIL TO HOUSING.**

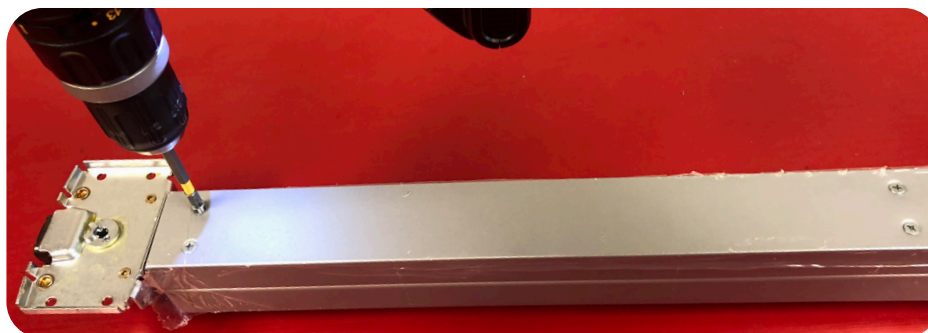

**13. HOOK UP TO POWER & SET PTS ACCORDING TO INSTRUCTIONS ON PAGE 2.**

